

Single Wing FB 7 Bullet Proof Door**Bullet Proof** **FB 7 NS** **in accordance with DIN EN 1522****Range of Dimensions:** **Width from 625 mm to 1500 mm**
Height from 1750 mm to 3000 mm

(* special options)

Technical specification and text for invitation to tender

Product:	PL-1 single wing bullet proof steel door brand Buchele in accordance with DIN EN 1522
Door Type:	SEC 1 / FB 7
Bullet Proof:	FB 7 NS
Dimensions: x mm
Door Leaf:	Double walled, level 70 mm thick steel door leaf, three sides folded with thin rebate without bottom stop. Special insulating inserts completely laid in and glued. Safety bolt screwed in door leaf fold.
Sill:	Floor bracket as stop sill. Surface galvanized and welded to the frame.
Frame:	3-sided circumferential folded corner frame with high-quality multi-chamber sealing profile adjustable fixed in the three sided groove.
Hinges:	Threepart height-adjustable construction hinges with hinge pin retention and ball-bearing spacer ring for smooth door movement.
Fitting:	2-point safety locking system with latch lever function in accordance with DIN EN 12209 (prepared for installation of a profile cylinder lock provided by customer). Safety door handle set with DIN EN 18257 firmly installed turnable aluminium F1 in U-shape with rounded protective plate.
Surface:	Door leaf and frame galvanized and primed with one component primer similar RAL 7001.
Mounting:	Delivery and professional assembly including filling of the cavities in the frame with mortar of group III.

Special Models

Standard Glazing:	Regular glazing – or insulated glazing BR7 held by steel glass bars. Minimum frieze width 125 mm on side and top, base 300 mm
Emergency Door:	With panic fitting in accordance with DIN EN 179 and 1125
Burglar Proof:	RC 2,RC 3,RC 4.
Sound Insulation:	Up to $R_{w,p}$ 51 dB with stop sill.
Stainless Steel:	Material 1.4301 (V2A) or. 1.4571 (V4A), surface bright mill or brushed.

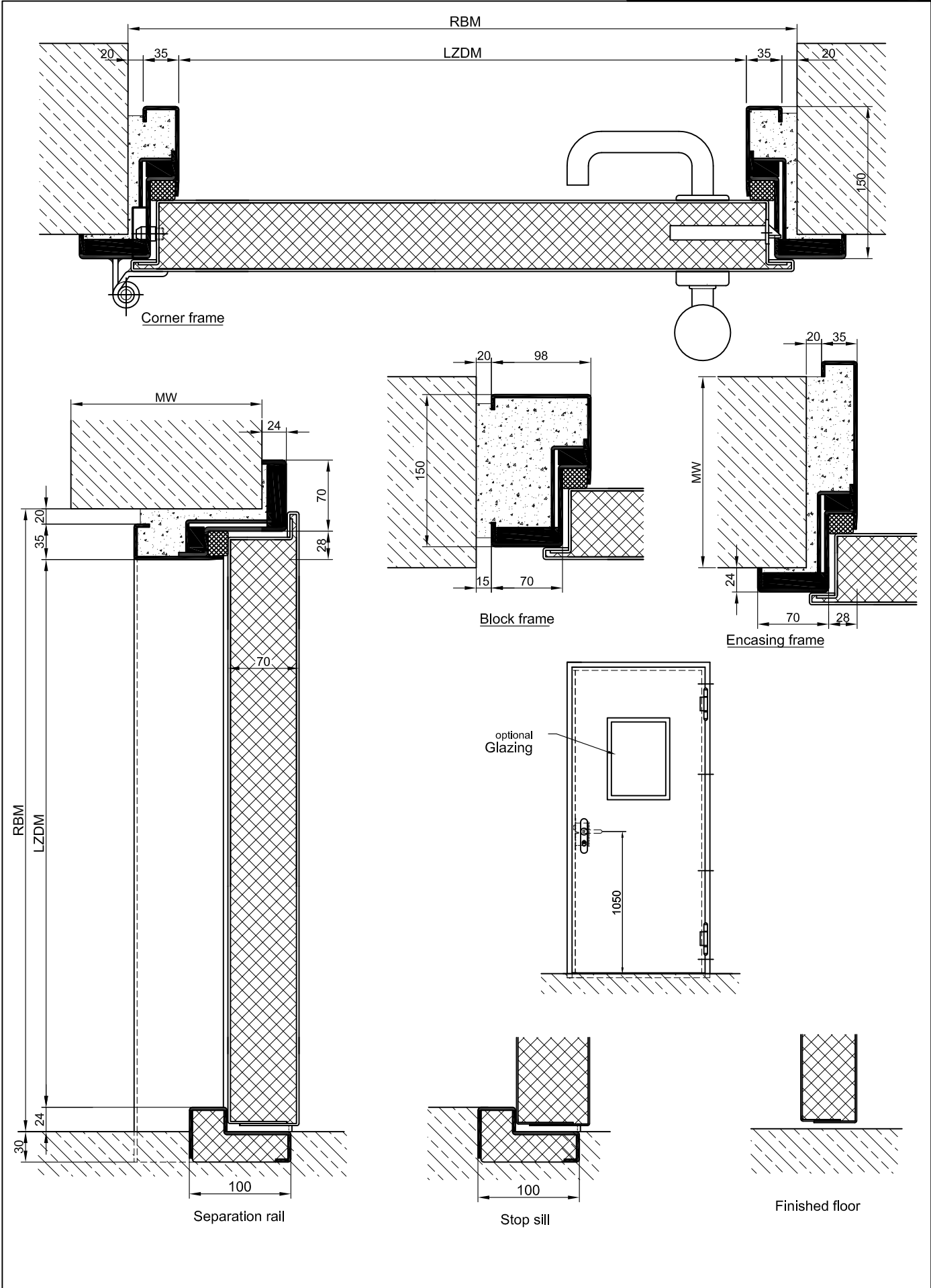

technische Änderungen vorbehalten - Stand 01/17